

# Asynchron-Pro types 8-pole

10/04/2026

## Power

Continuous power for efficient water cooling

The peak power is considerably higher.

Speed	in krpm	0.5	1	1.5	2	2.5	3	3.5	4	4.5	5	6	8	10	12	15
Frequency	in Hz	34	67	100	134	167	200	234	267	300	334	400	534	667	800	1000
Types (D1/LFe in cm)		Power in kW														
mW 16/8-8-s1r..	2.2	4.3	6.5	8.6	10.8	12.9	14.4	15.7	15.8	15.8	14.5	11.9				
mW 16/10-8-s1r..	2.8	5.7	8.5	11.3	14.2	17	18.8	20	20	20						
mW 16/12.5-8-s1r..	3.6	7.2	10.7	14.3	17.9	21	25	28	28	28	25	21				
mW 16/17-8-s1r..	4.9	9.9	14.8	19.7	25	30	33	36	36	36	33	27				
mW 16/20-8-s1r..	6	11.9	17.9	24	30	36	40	43	44	44	40	33				
mW 16/22-8-s1r..	6.6	13.1	19.7	26	33	39	44	48	48	48	44	36				
mW 16/27-8-s1r..	8.2	16.5	25	33	41	49	55	60	60	60	55	45				
mW 18/8-8-s1r..	2.8	5.5	8.3	11	13.8	16.5	18.3	19.8	20	20	20					
mW 18/12-8-s1r..	4.2	8.4	12.6	16.8	21	25	28	31	31	31	31					
mW 18/18-8-s1r..	6.4	12.8	19.2	26	32	38	43	48	48	48	48	45				
mW 18/24-8-s1r..	9	18	27	36	45	54	60	66	67	67	67					
mW 18/33-8-s1r..	12.5	25	37	50	62	75	84	92	93	93						
mW 18/38-8-s1r..	14.4	29	43	58	72	86	97									
mW 20/16-8-s1r..	7.7	15.4	23	31	34	38	38	38	38	38	38	37	36	35	33	
mW 20/22-8-s1r..	10.7	21	32	43	48	53	53	53	53	53	52	49	47	44	40	
mW 20/26-8-s1r..	12.9	26	39	52	57	63	63	63	63	63	62	59	57	54	50	
mW 20/30-8-s1r..	15.3	31	46	61	68	74	75	75	75	75	75	73	70	68		
mW 20/39-8-s1r..	20	40	60	80	89	97	98	98	96	95	92					
mW 30/13-8-s2r..	16.4	33	49	66	66	66	66	66	66	66	66	66	66			
mW 30/16-8-s2r..	21	42	63	63	63	63	63	63	63	63	63	63	63			
mW 30/26.5-8-s2r..	37	74	74	74	74	74	74	74	74	74	74	74	74			
mW 30/35-8-s2r..	52	104	105	105	105	105	105	105	105	105	105	105	105			
mW 30/41-8-s2r..	60	119	120	120	120	120	120	120	120	120	120	120	120			
mW 30/48-8-s2r..	72	144	145	145	145	145	145	145	145	145	145	145	145			



# Dimension sheet

Sketch

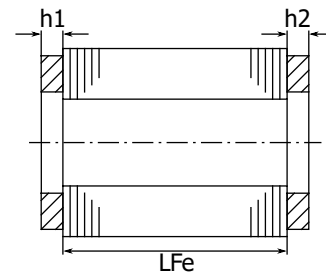
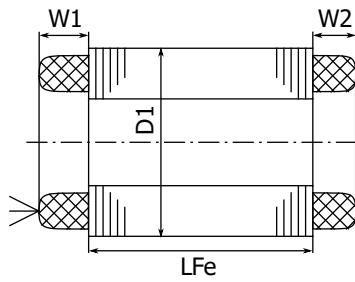

Main dimensions all dimensions in mm	Stator			Rotor						
	Outer diameter D1	Length of winding head		Bore				Ring length		
		W1	W2	d3 min		d3 max		h		
	Typ (D1/LFe in cm)	with PTC		Al	Cu	Al	Cu	Al	Cu	CuSt
mW 16/ .. -8-s1r..	160	43	30	-	74	-	80	-	6	-
mW 18/ .. -8-s1r..	180	40	30	-	87	-	90	-	6	-
mW 20/ .. -8-s1r..	200	46	33	-	98	-	100	-	5	14
mW 30/ .. -8-s2r..	300	49	40	-	147.5	-	153	-	5	11